



| MACHINETYPE   | SIZE            | POWER <sup>1)</sup> | CRUSHER SHAFT | Dimensions LxWxH <sup>2)</sup> |
|---|-----------------|---------------------|---------------|--------------------------------|
|  | HL II - 1617 ES | 2x 132 KW           | 1700mm        | 12300x2440x3600                |
|   | HL II - 1622 ES | 2x 160 KW           | 2100mm        | 12780x2440x3600                |
|   | HL II - 1626 ES | 2x 160 KW           | 2620mm        | 13300x2440x3600                |

### ELECTRO-STATIONARY

|   |                 |        |        |                 |
|---|-----------------|--------|--------|-----------------|
|  | HL II - 1617 DM | 280 KW | 1700mm | 12000x2550x4150 |
|   | HL II - 1622 DM | 370 KW | 2100mm | 12400x2550x4150 |
|   | HL II - 1626 DM | 370 KW | 2620mm | 12800x2550x4150 |

### MOBILE 3-AXLE TRAILER

|   |                 |        |        |                 |
|---|-----------------|--------|--------|-----------------|
|  | HL II - 1617 DK | 280 KW | 1700mm | 10300x2440x3750 |
|   | HL II - 1622 DK | 370 KW | 2100mm | 10800x2440x3750 |
|   | HL II - 1626 DK | 370 KW | 2620mm | 11200x2440x3750 |

### CRAWLER TRACKS

|   |                 |        |        |                 |
|---|-----------------|--------|--------|-----------------|
|  | HL II - 1617 DH | 280 KW | 1700mm | 10600x2550x3130 |
|   | HL II - 1622 DH | 370 KW | 2100mm | 11100x2550x3130 |
|   | HL II - 1626 DH | 370 KW | 2620mm | 11500x2550x3130 |

### HOOK LIFT FRAME

All details are approximate values of the standard version.

Machine equipment and accessories as required.

<sup>1)</sup> Optional drive power possible

<sup>2)</sup> Dimensions in working position



SINGLE-SHAFT CRUSHER

TWIN-SHAFT CRUSHER

SHREDDER

FINE SHREDDER

WOOD CHIPPER

ENVIRONMENTAL TECHNOLOGY



# Husmann

## Zerkleinerungstechnik

Maschinen- und Landmaschinenfabrik Husmann GmbH

Gerhard-Husmann-Straße 2

D-49762 Lathen

Tel.: +49 (0) 59 33 / 93 18 - 0

Fax: +49 (0) 59 33 / 93 18 - 50

info@husmann-web.de

<https://husmann-zerkleinerungstechnik.de>



Technical changes, misprints and errors excepted. Status 04/2024

# HL II

TWIN-SHAFT CRUSHER (asynchronous)

HL II 1617 (1700mm crusher shaft)

HL II 1622 (2100mm crusher shaft)

HL II 1626 (2620mm crusher shaft)



# Husmann HL II

Zerkleinerungstechnik

Twin-shaft crusher (asynchronous)

The "HL II" series as a crusher with two crusher shafts is suitable for both normal and extreme materials and guarantees a high throughput rate. The asynchronously driven crusher shafts enable the perfect crushing program for all materials.

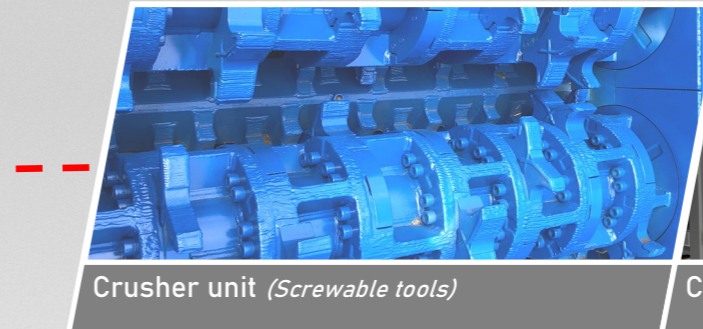
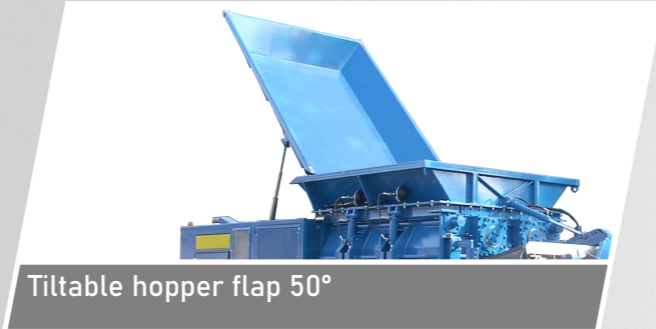
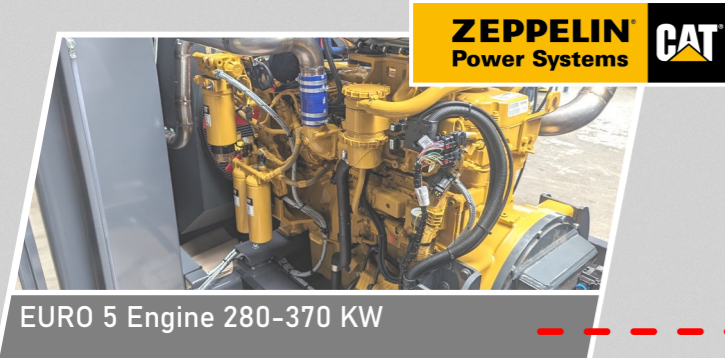

The specially shaped tools on the shafts and the counter-crushers enable machine operation in both shaft rotation directions. This ensures an increased throughput rate.

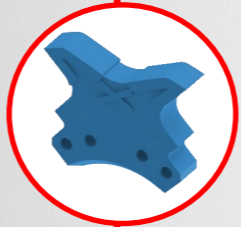

Examples of applications

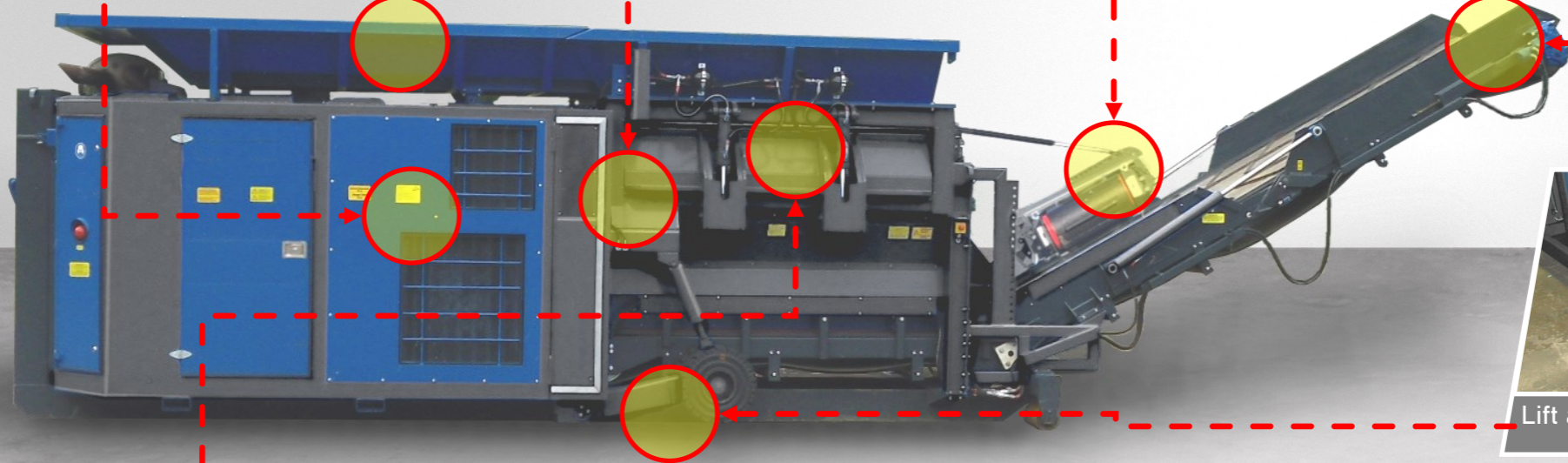

The HL II is equipped with hydraulic driven lateral ejection combs. In case of an overload the ejection flaps open automatically and allow the jammed material to fall through the crushing unit. This makes the machine less sensitive to foreign material matter and reduces downtimes.

